

MECH FLOW SUPPLIES

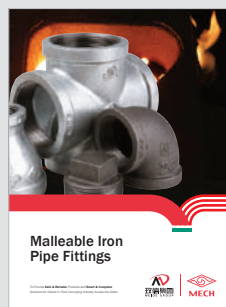

Malleable Iron
Pipe Fittings



Ductile Iron
Grooved Fittings
and Couplings



Valves



Cast Bronze
Fittings

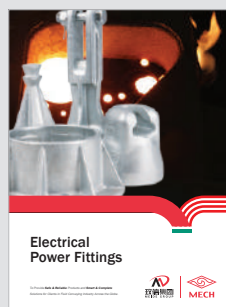

Electrical
Power Fittings

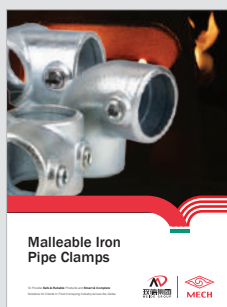

Malleable Iron
Pipe Clamps

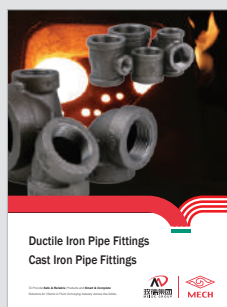

Ductile Iron Pipe Fittings
Cast Iron Pipe Fittings

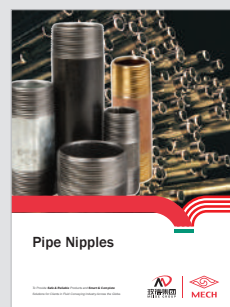

Pipe Nipples



JINAN MEIDE CASTING CO., LTD.

Address: Meide Science & Technology Park,
Industrial Park Pingyin, Jinan, China 250400

Phone: (86)531 87856271 87879384 87885060

Fax: (86)531 87879387

Email: info@meide-casting.com

Http: www.meide-casting.com

UPDATED 03/2020



Valves Brass

To Provide **Safe & Reliable** Products and **Smart & Complete**
Solutions for Clients in Fluid Conveying Industry Across the Globe.



More than 50 years of Foundry Experience

Company Profile

Meide Group is a high-tech enterprise specialized in supplying fittings and valves in fluid industry. The company has won more than 400 great honors, such as Single Champion Demonstration Enterprise, Green Manufacturing Enterprise, China's top 100 Light Industrial Enterprise, China's Leading Enterprise of Malleable Iron Pipe Fitting Production Base, National Enterprise with Good Creditworthiness and China's Famous Brand.

Inheriting the originality, and striving for excellence. "MECH" brand products are widely used in Burj Khalifa, dubai, new WTC in New York, Shanghai Tower, UHV transmission lines and other landmark buildings and projects such as Beijing-Shanghai high-speed railway. Adhering to the customer-centered product development and innovation concept, to meet and guide the growing needs of users, to provide safe & reliable products and smart & complete solutions for clients in fluid industry across the globe, Meide Group has become the industry leader.

Using development innovation platform such as National Enterprise Technical Center and Post-Doctoral Research Center, Meide Group is promoting the transformation of technology innovation achievements into productive forces, has completed the transformation of production process from mechanization to automation and intelligence, management from experience to institutionalization and process, marketing is from selling products to offering solutions, steadily improve Meide Group's role in the global value chain.

Through the construction of three production bases, including Jinan, Linyi and Bangkok, Meide Group has formed a cross-regional, multi-base international development pattern. Meide Group never forgets the original intention, operates in compliance, keeps growing, insists on sharing development results with customers, employees, shareholders and the community, and strive to be a happy and respectable company.

Company History

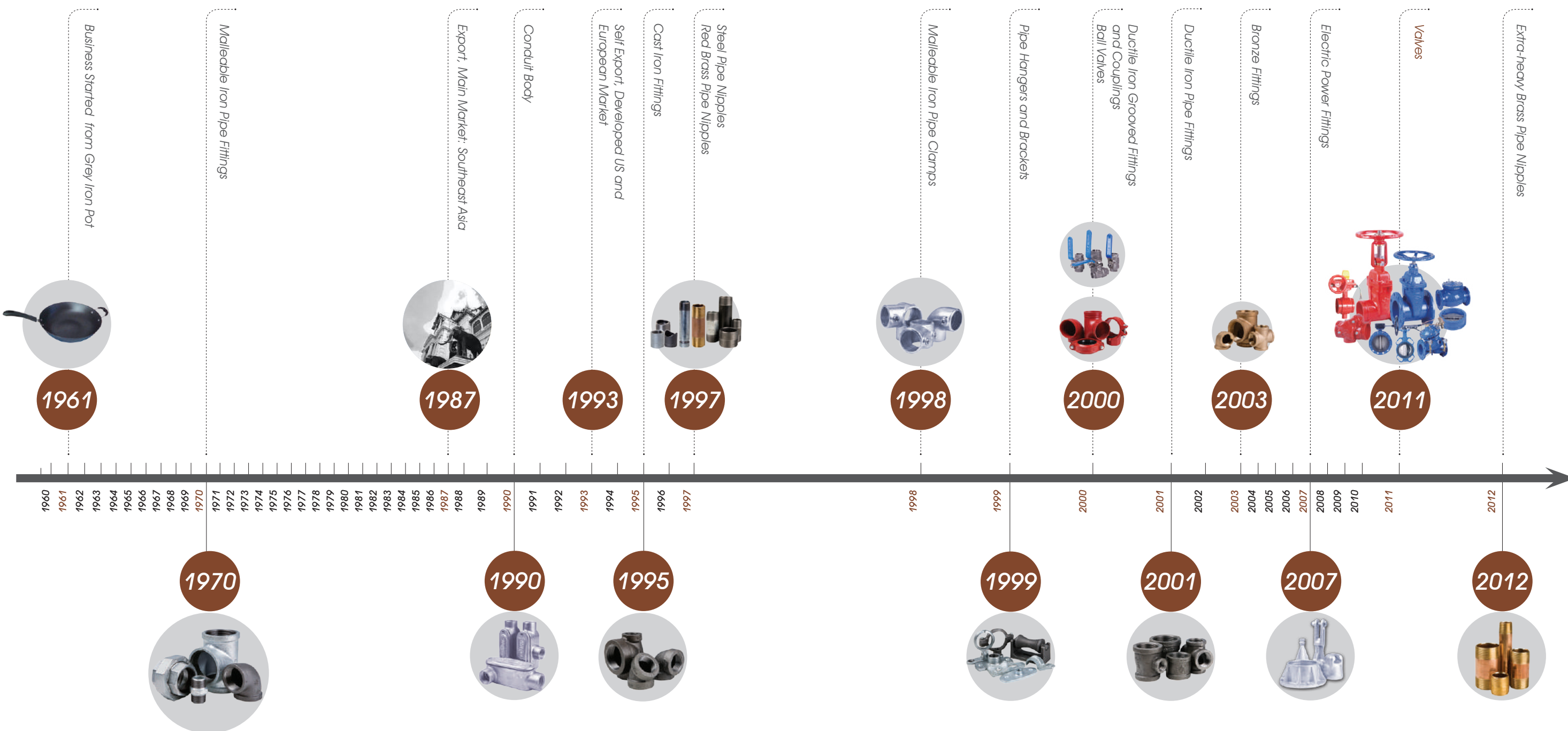

Reliable Quality Assurance

Jinan Meide is honored as the National enterprise technical center and is capable and qualified to conduct full series of tests and inspections including chemical checking, etc.

Inspection facilities include: spectrometer, carbon sulfur analyzer, metallurgical microscope, tensile strength testing equipment, pressure testing equipment, adhesive force testing equipment, CMM, hardness tester, etc.

From incoming inspection to finished product, quality is checked and monitored in the whole process. Each step of the manufacturing process is carefully documented, regularly reviewed for revision control and updating standard. Quality procedures are constantly monitored and updated to assure that only the highest and most consistent quality products are supplied to our valued customers.



Metallurgical Microscope



R & D



Spectrometer

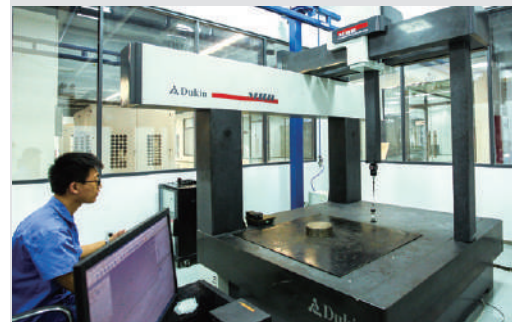

CMM



Projector



Pipe line



Valve Pressure Testing Machine (Vertical)



Endurance Test Machine



Valve Pressure Testing Machine (Horizontal)

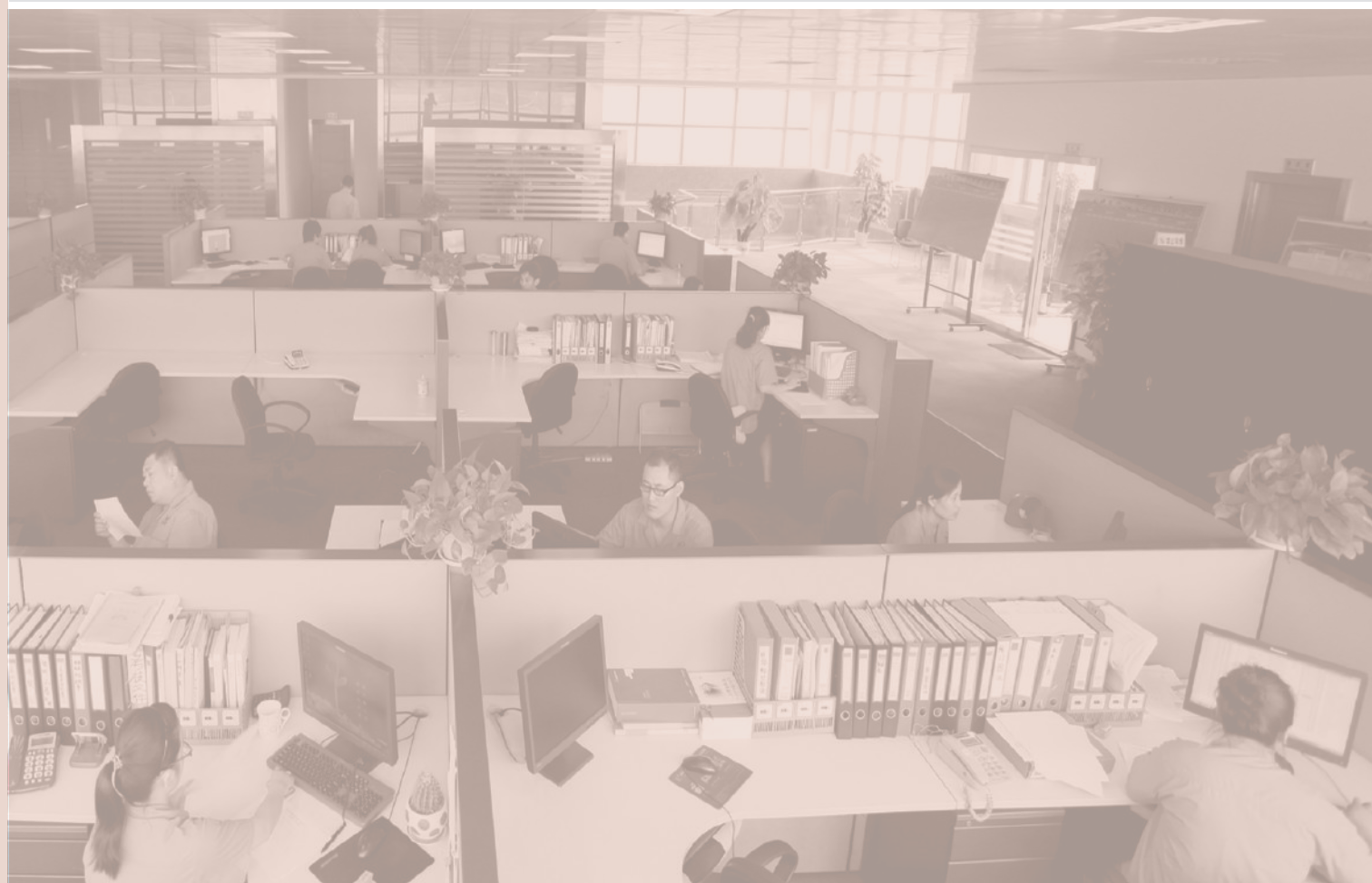

Certificates

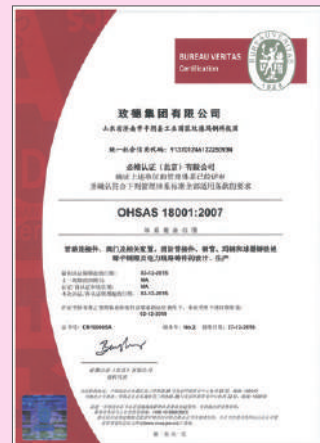

• Z15W-101A

Brass Gate Valve



• CZ15W-103A

Brass Magnetic Encryption Gate Valve



• JZ15W-104A

Brass Triangle Lock Gate Valve



• J11W-301A

Brass Globe Valve

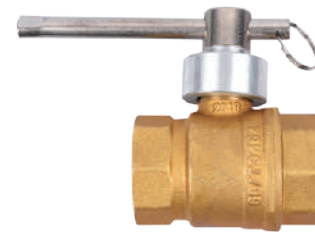

• CQ11F-206A

Brass Lock Ball Valve



• Q11F-201A

Brass Ball Valve



• H14W-401A

Brass Check Valve



• H12X-403A

Brass In-Line Check Valve



• V1-601A

Brass Y-type Strainer



• Y11X-702A

Brass Pressure Reducing Valve



• B21X

Brass Air Bleeding Valve

Brass Gate Vavle
(Z15W-101A)

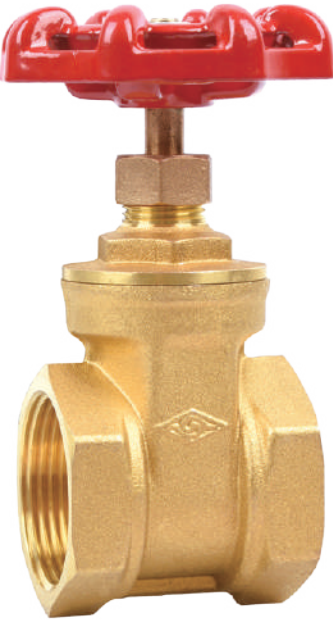

Z15W-101A

- Connection Ends: ISO 228
- Working Pressure: PN16
- Temperature Range: -10°C- 100°C

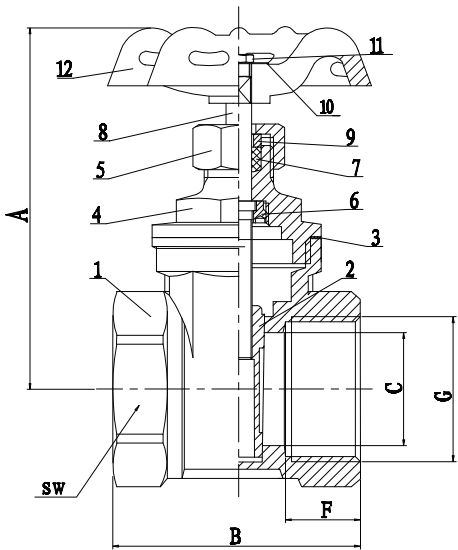

MATERIAL SPECIFICATION

Part No.	Part	Standard Specification
1	Body	Brass HPb59-1
2	Valve Plate	Brass HPb57-3
3	Sealing Ring	PTFE
4	Cover	Brass HPb59-1
5	Pressure Cap	Brass HPb57-3
6	O-Rings	NBR
7	Stem Packing	PTFE
8	Stem	Brass HPb57-3
9	Stem Bushing	Brass HPb57-3
10	Nameplate	AL
11	Gland Nut	Q235
12	Handwheel	ISO 185/ JL/ 200

Note: For special material request other than standard specification, please indicate clearly on the inquiry or order list.

DN		PN	Dimensions(mm)				
Inch	mm		A	B	C	F	SW
1/2"	15	16	67	43	13	12.5	25
3/4"	20	16	74	47	17	13.5	32
1"	25	16	82	50	21.5	14.5	38
1 1/4"	32	16	92	54	26	15	47
1 1/2"	40	16	106	56	31	15.5	53
2"	50	16	128	64	40	16.5	66

Brass Magnetic Encryption Gate Valve
(CZ15W-103A)

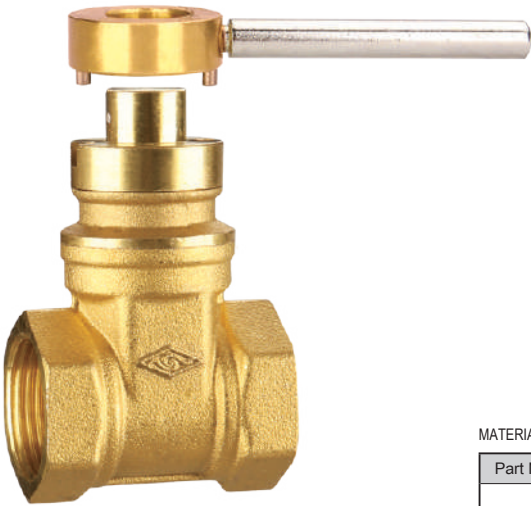

CZ15W-103A

- Connection Ends: ISO 228
- Working Pressure: PN16
- Temperature Range: -10°C- 100°C

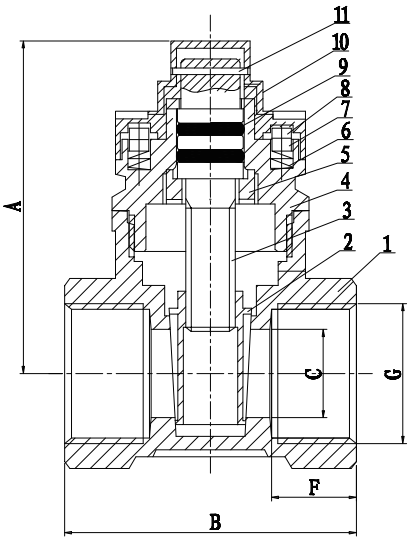

MATERIAL SPECIFICATION

Part No.	Part	Standard Specification
1	Body	Brass HPb59-1
2	Plate	Brass HPb57-3
3	Stem	Brass HPb57-3
4	Cover	Brass HPb59-1
5	Locking Cap	Brass HPb57-3
6	Spring	SS304
7	Top Bar	Brass HPb57-3
8	Magnet	Nd2Fe14B
9	O-Rings	NBR
10	Magnetic Cover	Brass HPb57-3
11	Pin	SS304

Note: For special material request other than standard specification, please indicate clearly on the inquiry or order list.

DN		PN	Dimensions(mm)			
Inch	mm		A	B	C	F
1/2"	15	16	50	43	13	12.5
3/4"	20	16	56	47	17	13.5
1"	25	16	65	50	21.5	14.5
1 1/4"	32	16	79	54	26	15
1 1/2"	40	16	91	58	32	16
2"	50	16	105	64	41	16.5

Brass Triangle Lock Gate Valve
(JZ15W-104A)



JZ15W-104A

- Connection Ends: ISO 228
- Working Pressure: PN16
- Temperature Range: -10°C- 100°C

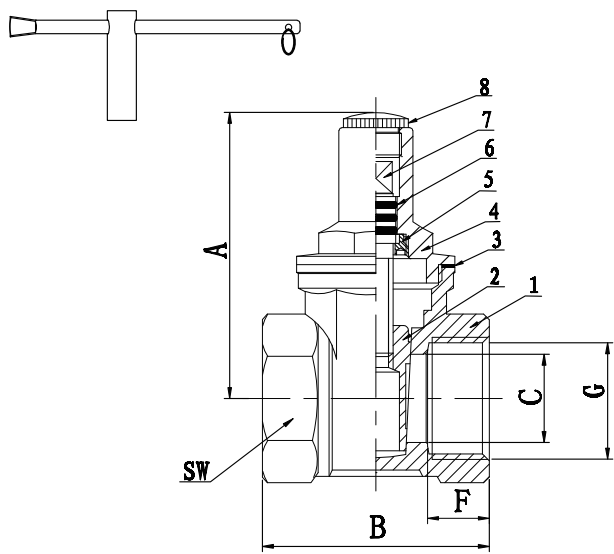

MATERIAL SPECIFICATION

Part No.	Part	Standard Specification
1	Body	Brass HPb59-1
2	Plate	Brass HPb57-3
3	Sealing Ring	PTFE
4	Cover	Brass HPb59-1
5	Locking Cap	Brass HPb57-3
6	O-Rings	NBR
7	Stem	Brass HPb57-3
8	Plug	ABS

Note: For special material request other than standard specification, please indicate clearly on the inquiry or order list.

DN		PN	Dimensions(mm)				
Inch	mm		A	B	C	F	SW
1/2"	15	16	61	43	13	12.5	25
3/4"	20	16	65	47	17	13.5	31.5
1"	25	16	73	49.5	21.5	14	38
1 1/4"	32	16	75	54	26	15	47
1 1/2"	40	16	78	56	31	15.5	53
2"	50	16	98	64	40	17	66

Brass Globe Vavle
(J11W-301A)

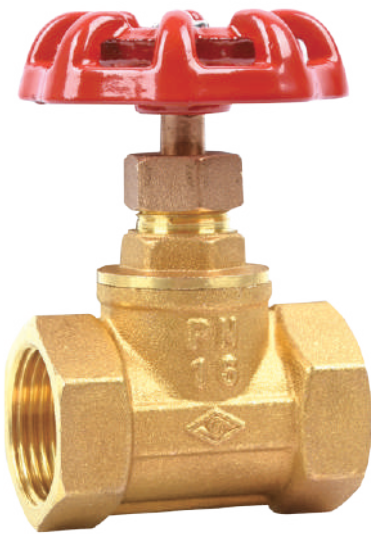

J11W-301A

- Connection Ends: ISO 228
- Working Pressure: PN16
- Temperature Range: 0°C- 120°C

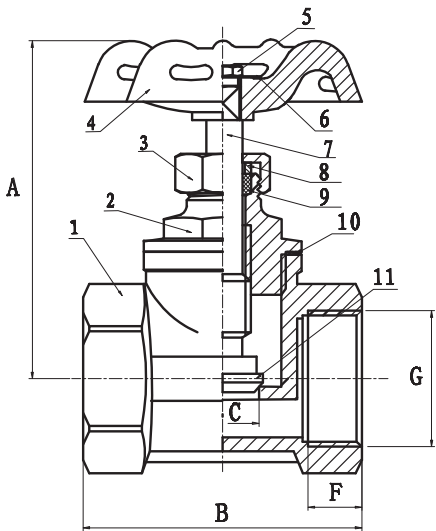

MATERIAL SPECIFICATION

Part No.	Part	Standard Specification
1	Body	HPb59-1
2	Cover	HPb59-1
3	Pressing Nut	HPb57-3
4	Handwheel	HT200
5	Hexagonal Nut	Q235
6	Nameplate	AL
7	Stem	HPb59-1
8	Retainer Ring	HPb57-3
9	Packing	PTFE
10	Sealing Ring	PTFE
11	Core	HPb57-3

Note: For special material request other than standard specification, please indicate clearly on the inquiry or order list.

DN		PN	Dimensions(mm)				
Inch	mm		A	B	C	F	G
1/2"	15	16	60	45	13.5	11.5	1/2
3/4"	20	16	64	54	16	12	3/4
1"	25	16	77	61	20	14	1
1 1/4"	32	16	96	74	28	15	1 1/4
1 1/2"	40	16	105	84	31	18	1 1/2
2"	50	16	119	94	35	19.5	2

Brass Lock Ball Valve
(CQ11F-206A)

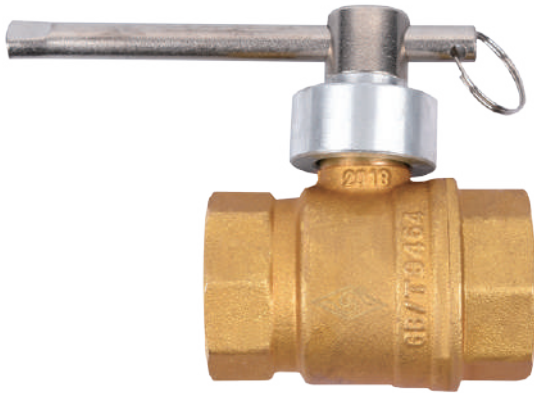

CQ11F-206A

- Connection Ends: ISO 228
- Working Pressure: PN16
- Temperature Range: -20°C- 120°C

MATERIAL SPECIFICATION

Part No.	Part	Standard Specification
1	Body	HPb59-1
2	Bonnet	HPb59-1
3	Valve Ball	HPb57-3
4	Seat	PTFE
5	Stem	HPb57-3
6	O-Ring	NBR
7	Pin	Stainless Steel
8	Lock Nut	HPb57-3

Note: For special material request other than standard specification, please indicate clearly on the inquiry or order list.

DN		PN	Dimensions(mm)	
Inch	mm		L	G
1/2"	15	16	53.5	1/2"
3/4"	20	16	57	3/4"
1"	25	16	64.5	1"
1 1/4"	32	16	74	1 1/4"
1 1/2"	40	16	83	1 1/2"
2"	50	16	94	2"

Brass Ball Valve
(Q11F-201A)



Q11F-201A

- Connection Ends: ISO 228
- Working Pressure: PN16
- Temperature Range: -20°C- 120°C

MATERIAL SPECIFICATION

Part No.	Part	Standard Specification
1	Sticky Plastic Handle	A3
2	Locknut	A3
3	Stem	HPb57-3
4	Pressure Cap	HPb57-3
5	Padding	PTFE
6	Seat	PTFE
7	Valve Ball	HPb57-3
8	Bonnet	HPb59-1
9	Body	HPb59-1

Note: For special material request other than standard specification, please indicate clearly on the inquiry or order list.

DN		PN	Dimensions(mm)					
Inch	mm		G	A	B	C	F	L
1/2"	15	16	1/2	50	53.5	14	12.5	90
3/4"	20	16	3/4	50	57	19	12.5	90
1"	25	16	1	59	64.5	23	13.5	103
1 1/4"	32	16	1 1/4	72	74	29	14.5	140
1 1/2"	40	16	1 1/2	77	83	37	15	140
2"	50	16	2	84	94	45	15	146

Brass Check Valve
(H14W-401A)



H14W-401

- Connection Ends: ISO 228
- Working Pressure: PN16
- Temperature Range: -20°C- 120°C

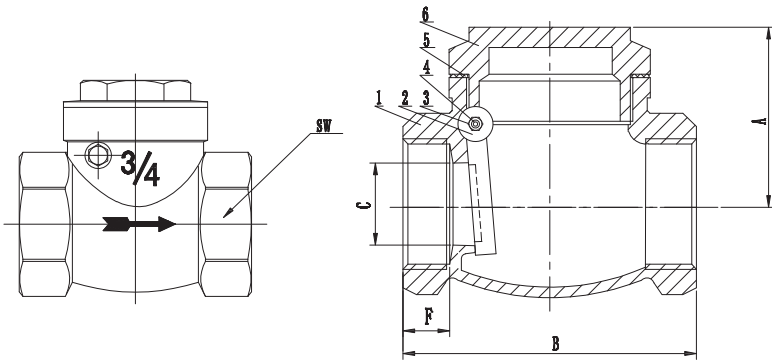

MATERIAL SPECIFICATION

Part No.	Part	Standard Specification
1	Body	HPb59-1
2	Disc	HPb57-3
3	Nut	HPb57-3
4	Pin	SS304
5	Gasket	Metal Anaerobic Adhesive
6	Bonnet	HPb59-1

Note: For special material request other than standard specification, please indicate clearly on the inquiry or order list.

DN		PN	Dimensions(mm)				
Inch	mm		A	B	C	F	SW
1/2"	15	16	33	47	13	10	26
3/4"	20	16	38	57.5	16	12.7	32
1"	25	16	41	62	22.5	13.5	40
1 1/4"	32	16	49	71	27	14.5	48
1 1/2"	40	16	58	82	31	16.5	55
2"	50	16	66	95	41	17	66.5

Brass In-Line Check Valve
(H12X-403A)

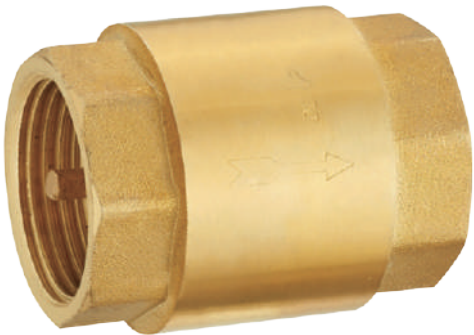

H12X-403A

- Connection Ends: ISO 228
- Working Pressure: PN16
- Temperature Range: -20°C- 120°C

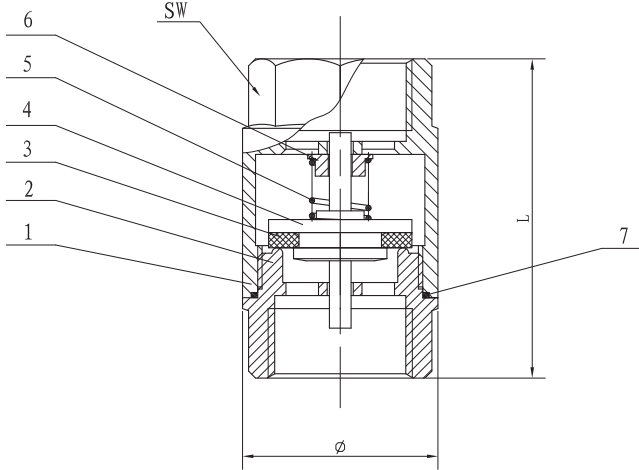

MATERIAL SPECIFICATION

Part No.	Part	Standard Specification
1	Body	HPb59-1
2	Bonnet	HPb59-1
3	Disc	Silicon Rubber
4	Valve Frame	HPb59-1
5	Spring	1Cr18Ni9Ti
6	Spring Seat	HPb59-1
7	Mouth Seal Ring	Teflon

Note: For special material request other than standard specification, please indicate clearly on the inquiry or order list.

DN		PN	Dimensions(mm)		
Inch	mm		Φ	L	SW
1/2"	15	16	31	46	24.5
3/4"	20	16	39	52	30
1"	25	16	45	58	38
1 1/4"	32	16	56	65	47
1 1/2"	40	16	61	70	52
2"	50	16	80	84	66

Brass Y-type Strainer
(V1-601A)

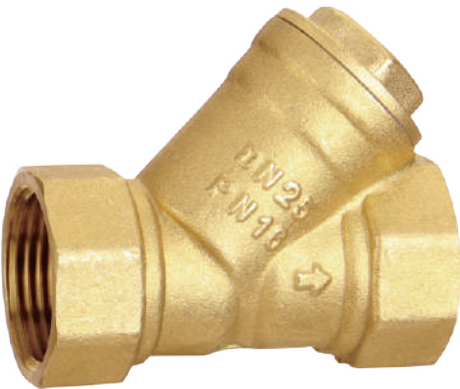

V1-601A

- Connection Ends: ISO 228
- Working Pressure: PN16
- Temperature Range: -20°C- 120°C

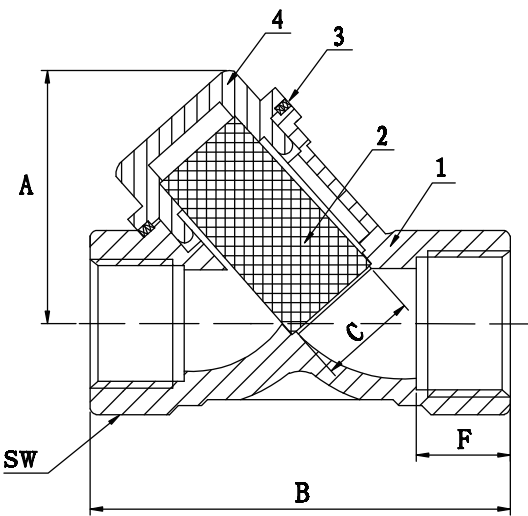

MATERIAL SPECIFICATION

Part No.	Part	Standard Specification
1	Body	Brass HPb59-1
2	Screen	SS304
3	Sealing Ring	PTFE
4	Cover	Brass HPb59-1

Note: For special material request other than standard specification, please indicate clearly on the inquiry or order list.

DN		PN	Dimensions(mm)				
Inch	mm		A	B	C	F	SW
1/2"	15	16	39	56	13	12	24.5
3/4"	20	16	47	69	21	12	33
1"	25	16	50	76	21	13	38.5
1 1/4"	32	16	65	94	27	15.5	47
1 1/2"	40	16	74	102	32	19	53.5
2"	50	16	88	120	42	19	67

Brass Pressure Reducing Valve
(Y11X-702A)



Y11X-702A

- Connection Ends: ISO 228
- Working Pressure: PN16
- Temperature Range: 0°C- 80°C

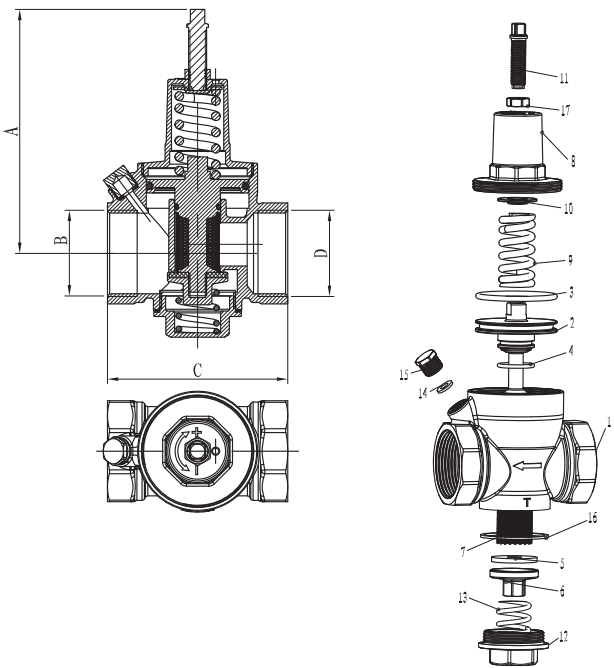

MATERIAL SPECIFICATION

Part No.	Part	Standard Specification
1	Valve Body	HPb59-1
2	Piston	HPb59-1
3	O-Ring	EPDM
4	O-Ring	EPDM
5	Gasket	EPDM
6	Piston Base	HPb59-1
7	Filter	Stainless Steel
8	Upper Bonnet	HPb59-1
9	Spring	Spring Steel
10	Gasket	Stainless Steel
11	Adjust Screw	Iron
12	Lower Bonnet	HPb59-1
13	Spring	Spring Steel
14	Gasket	NBR
15	Plug	HPb57-3
16	Gasket	PTFE
17	Hexagonal Nut	Q235

Note: For special material request other than standard specification, please indicate clearly on the inquiry or order list.

DN		PN	Dimensions(mm)			
Inch	mm		A	B (G)	C	D (G)
1/2"	15	16	77	1/2	72	1/2
3/4"	20	16	96	3/4	75	3/4
1"	25	16	110	1	78	1
1 1/4"	32	16	117	1 1/4	85	1 1/4
1 1/2"	40	16	161	1 1/2	100	1 1/2
2"	50	16	163	2	113.5	2

Brass Air Bleeding Valve
(B21X)



B21X

- Connection Ends: ISO 7-1
- Working Pressure: PN16
- Temperature Range: 0°C- 80°C

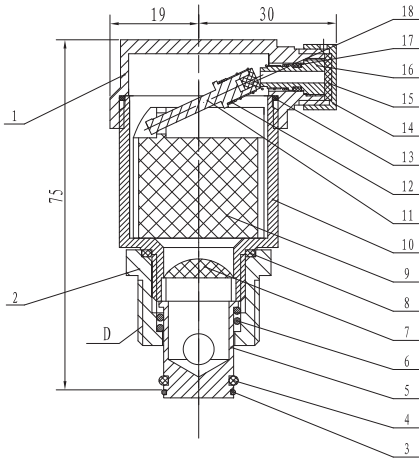

MATERIAL SPECIFICATION

Part No.	Part	Standard Specification
1	Cover	HPb59-1
2	Joint Seat	HPb59-1
3	Elastic Ring	1Cr18Ni9Ti
4	O-Ring	NBR
5	Recovery Seat	HPb59-1
6	Spring	1Cr18Ni9Ti
7	Filter	1Cr18Ni9Ti+H62
8	O-Ring	NBR
9	Plastic Float	Polypropylene
10	Valve Body	HPb59-1
11	Needle Valve	HPb59-1
12	Spring	1Cr18Ni9Ti
13	O-Ring	NBR
14	End Cover	HPb59-1
15	Gasket	Silicon Rubber
16	Seat	HPb59-1
17	O-Ring	NBR
18	Sealing Plug	NBR

Note: For special material request other than standard specification, please indicate clearly on the inquiry or order list.

DN		PN	Dimensions(mm)			
Inch	mm		A	B	C	D (R)
1/2"	15	16	30	19	75	1/2
3/4"	20	16	30	19	75	3/4
1"	25	16	30	19	75	1

